

Vibration-damping elements

Silicone rubber and stainless steel

BASE

AISI 304 stainless steel.

VIBRATION-DAMPING BODY

Silicone rubber (MVQ) RAL 7040 grey colour, in compliance with FDA (U.S. Food and Drug Administration), giving the possibility to use in the food and medical industry.

- Hardness 55 Shore A ± 5 .
- High resistance to ageing.
- Resistance to high temperatures (up to 200°C) and low temperatures (-50°C).

STANDARD EXECUTIONS

- **DVF.6-SST**: AISI 304 stainless steel threaded stud.
- **DVF.7-SST**: AISI 304 stainless steel boss, threaded blind hole.

FEATURES AND APPLICATIONS

DVF.6 and DVF.7 vibration-damping elements have been designed to damp vibrations, shocks and noises produced by moving bodies or non-balanced vibrating masses of equipment and machines.

DVF.6 and DVF.7 elements are generally used as a bumper or as a limit stop for the absorption of vibrations, and for preventing:

- malfunctioning and reduction of the machine lifespan and/or of the adjacent ones;
- noise and thus also damage to health.

Load diagrams for each single code are available on request.

See technical data and guidelines for the choice on page A53

SPECIAL EXECUTIONS ON REQUEST

Silicone rubber (MVQ) in compliance with FDA, hardness 40, 70 Shore A ± 5 .



DVF.6-SST

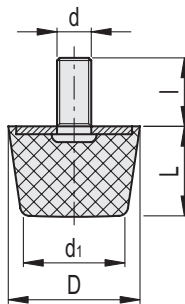

DVF.6 - 20 - 17 - SST - M5 - 6 - 55

D L Stainless steel d l Shore A

DVF.6-SST

STAINLESS STEEL

| Code | Description | D | L | d | d1 | l | Max. load [N] | Max. deflection [mm] | Stiffness [N/mm] | ⚖️ |
|--------|--------------------------|----|----|----|----|----|---------------|----------------------|------------------|----|
| 432801 | DVF.6-20-17-SST-M5-6-55 | 20 | 17 | M5 | 10 | 6 | 197 | 4.25 | 46 | 14 |
| 432802 | DVF.6-20-17-SST-M5-10-55 | 20 | 17 | M5 | 10 | 10 | 197 | 4.25 | 46 | 15 |
| 432803 | DVF.6-20-17-SST-M5-20-55 | 20 | 17 | M5 | 10 | 20 | 197 | 4.25 | 46 | 17 |
| 432811 | DVF.6-20-17-SST-M6-12-55 | 20 | 17 | M6 | 10 | 12 | 197 | 4.25 | 46 | 16 |
| 432812 | DVF.6-20-17-SST-M6-18-55 | 20 | 17 | M6 | 10 | 18 | 197 | 4.25 | 46 | 17 |
| 432813 | DVF.6-20-17-SST-M6-25-55 | 20 | 17 | M6 | 10 | 25 | 197 | 4.25 | 46 | 19 |
| 432821 | DVF.6-25-17-SST-M6-8-55 | 25 | 17 | M6 | 19 | 8 | 580 | 4.25 | 137 | 18 |
| 432822 | DVF.6-25-17-SST-M6-12-55 | 25 | 17 | M6 | 19 | 12 | 580 | 4.25 | 137 | 19 |
| 432823 | DVF.6-25-17-SST-M6-18-55 | 25 | 17 | M6 | 19 | 18 | 580 | 4.25 | 137 | 20 |
| 432824 | DVF.6-25-17-SST-M6-25-55 | 25 | 17 | M6 | 19 | 25 | 580 | 4.25 | 137 | 21 |

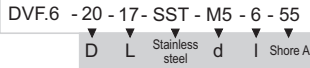

DVF.6-SST

STAINLESS STEEL

| Code | Description | D | L | d | d1 | l | Max. load [N] | Max. deflection [mm] | Stiffness [N/mm] | ⚖️ |
|--------|---------------------------|----|----|-----|----|----|---------------|----------------------|------------------|-----|
| 432831 | DVF.6-32-22-SST-M8-10-55 | 32 | 22 | M8 | 24 | 10 | 751 | 5.5 | 137 | 30 |
| 432832 | DVF.6-32-22-SST-M8-16-55 | 32 | 22 | M8 | 24 | 16 | 751 | 5.5 | 137 | 32 |
| 432833 | DVF.6-32-22-SST-M8-23-55 | 32 | 22 | M8 | 24 | 23 | 751 | 5.5 | 137 | 35 |
| 432834 | DVF.6-32-22-SST-M8-30-55 | 32 | 22 | M8 | 24 | 30 | 751 | 5.5 | 137 | 37 |
| 432841 | DVF.6-38-35-SST-M8-10-55 | 38 | 35 | M8 | 30 | 10 | 1311 | 8.75 | 150 | 70 |
| 432842 | DVF.6-38-35-SST-M8-16-55 | 38 | 35 | M8 | 30 | 16 | 1311 | 8.75 | 150 | 74 |
| 432843 | DVF.6-38-35-SST-M8-30-55 | 38 | 35 | M8 | 30 | 30 | 1311 | 8.75 | 150 | 79 |
| 432851 | DVF.6-38-35-SST-M10-12-55 | 38 | 35 | M10 | 30 | 12 | 1311 | 8.75 | 150 | 75 |
| 432852 | DVF.6-38-35-SST-M10-20-55 | 38 | 35 | M10 | 30 | 20 | 1311 | 8.75 | 150 | 79 |
| 432853 | DVF.6-38-35-SST-M10-28-55 | 38 | 35 | M10 | 30 | 28 | 1311 | 8.75 | 150 | 82 |
| 432854 | DVF.6-38-35-SST-M10-40-55 | 38 | 35 | M10 | 30 | 40 | 1311 | 8.75 | 150 | 86 |
| 432861 | DVF.6-43-50-SST-M10-12-55 | 43 | 50 | M10 | 30 | 12 | 1318 | 12.5 | 105 | 98 |
| 432862 | DVF.6-43-50-SST-M10-20-55 | 43 | 50 | M10 | 30 | 20 | 1318 | 12.5 | 105 | 101 |
| 432863 | DVF.6-43-50-SST-M10-28-55 | 43 | 50 | M10 | 30 | 28 | 1318 | 12.5 | 105 | 105 |
| 432864 | DVF.6-43-50-SST-M10-40-55 | 43 | 50 | M10 | 30 | 40 | 1318 | 12.5 | 105 | 110 |
| 432871 | DVF.6-50-20-SST-M10-12-55 | 50 | 20 | M10 | 40 | 12 | 2890 | 5 | 578 | 72 |
| 432872 | DVF.6-50-20-SST-M10-20-55 | 50 | 20 | M10 | 40 | 20 | 2890 | 5 | 578 | 75 |
| 432873 | DVF.6-50-20-SST-M10-28-55 | 50 | 20 | M10 | 40 | 28 | 2890 | 5 | 578 | 78 |
| 432874 | DVF.6-50-20-SST-M10-40-55 | 50 | 20 | M10 | 40 | 40 | 2890 | 5 | 578 | 82 |
| 432881 | DVF.6-60-40-SST-M10-12-55 | 60 | 40 | M10 | 40 | 12 | 2830 | 10 | 283 | 295 |
| 432882 | DVF.6-60-40-SST-M10-20-55 | 60 | 40 | M10 | 40 | 20 | 2830 | 10 | 283 | 301 |
| 432883 | DVF.6-60-40-SST-M10-28-55 | 60 | 40 | M10 | 40 | 28 | 2830 | 10 | 283 | 308 |
| 432884 | DVF.6-60-40-SST-M10-40-55 | 60 | 40 | M10 | 40 | 40 | 2830 | 10 | 283 | 316 |

DVF.7-SST

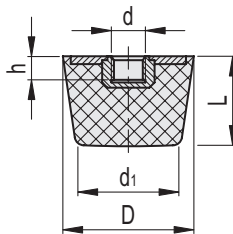

DVF.7-SST

STAINLESS STEEL

| Code | Description | D | L | d | d1 | h | Max. load [N] | Max. deflection [mm] | Stiffness [N/mm] | ⚖️ |
|--------|------------------------|----|----|-----|----|----|---------------|----------------------|------------------|-----|
| 432901 | DVF.7-20-17-SST-M5-55 | 20 | 17 | M5 | 10 | 5 | 211 | 4.25 | 50 | 16 |
| 432902 | DVF.7-20-17-SST-M6-55 | 20 | 17 | M6 | 10 | 6 | 211 | 4.25 | 50 | 14 |
| 432906 | DVF.7-25-17-SST-M6-55 | 25 | 17 | M6 | 10 | 6 | 605 | 4.25 | 142 | 15 |
| 432911 | DVF.7-32-22-SST-M8-55 | 32 | 22 | M8 | 24 | 8 | 778 | 5.5 | 142 | 18 |
| 432916 | DVF.7-38-35-SST-M8-55 | 38 | 35 | M8 | 30 | 8 | 1455 | 8.75 | 166 | 74 |
| 432917 | DVF.7-38-35-SST-M10-55 | 38 | 35 | M10 | 30 | 10 | 1455 | 8.75 | 166 | 70 |
| 432921 | DVF.7-43-50-SST-M10-55 | 43 | 50 | M10 | 30 | 10 | 1420 | 12.5 | 114 | 98 |
| 432931 | DVF.7-50-20-SST-M10-55 | 50 | 20 | M10 | 40 | 10 | 3010 | 5 | 602 | 75 |
| 432941 | DVF.7-60-40-SST-M10-55 | 60 | 40 | M10 | 40 | 10 | 2990 | 10 | 299 | 125 |



Machine elements 9