

## Hole reduction sleeves with spherical seats

for TCC connecting clamps, technopolymer

### MATERIAL

Glass-fibre reinforced polyamide based (PA) technopolymer, RAL 9005 (C9) black colour or grey RAL 7040 (C33) colour, matte finish.

### FEATURES AND APPLICATIONS

Hole reduction sleeves with spherical seats are suitable for ball diameter 'd<sub>1</sub>' 14 mm of the base with ball joint TCC-SJB (see page -) and of the double ball joint TCC-SJD (see page -).

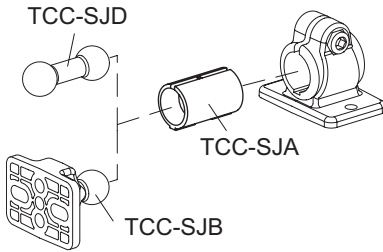

ELESA Original design

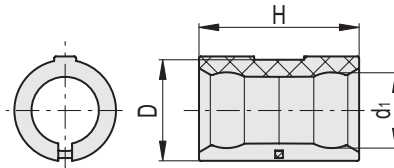

C9 RAL9005 C33 RAL7040

Code	Description	D	H	d <sub>1</sub>	△
600161-C9	TCC-SJA-18-S14-C9	18	29	14	5
600161-C33	TCC-SJA-18-S14-C33	18	29	14	5